

OUTSIDE "T" COPING MITERS

RIGHT OUTSIDE "T" MITER

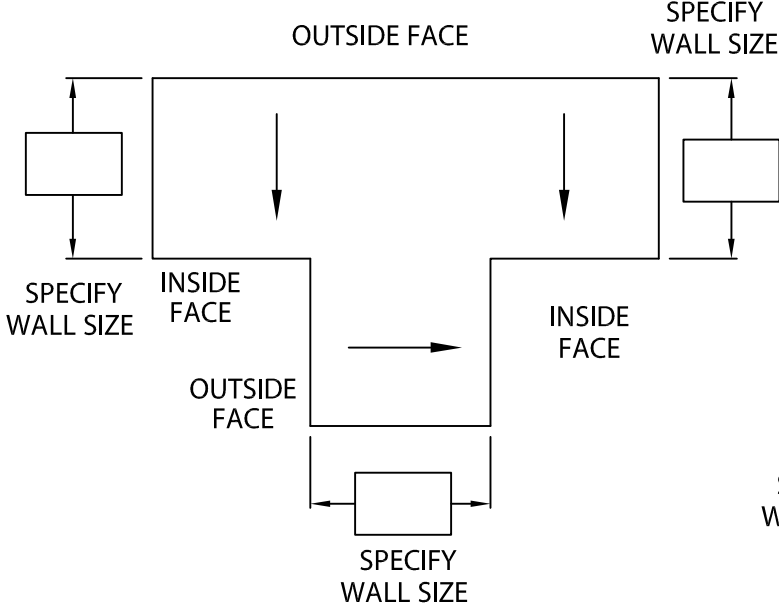

LEFT OUTSIDE "T" MITER

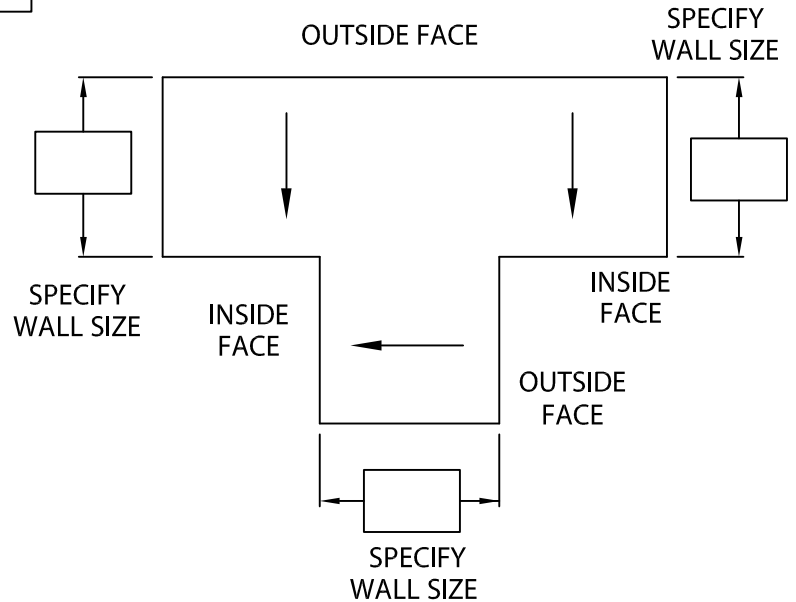

NOTES: -- Concealed splice plates are provided with factory applied dual non-curing sealant strips.

-- Unless otherwise noted, fabrication of miters and accessories are furnished standard utilizing a non-penetrating quicklock joint, then factory sealed watertight.

Fabrication will proceed only after receipt of signed print approval.

Print Approval:

Architect and/or contractor shall verify all dimensions, sizes and quantities. All products to be installed in strict accordance with Petersen Aluminum's printed instructions.

Approved by: _____

Date: _____

-- Welded Miters and Accessories

Check one Required (surcharge) Not applicable

MATERIAL:

___ 24 Ga. (.65 mm) Steel

___ .040" (1.01 mm) Alum.

Color: _____

___ .050" (1.27 mm) Alum.

___ .063" (1.60 mm) Alum.

Finish: _____

___ Other _____

QUANTITIES:

_____ Right Outside "T" Miter(s)

_____ Left Outside "T" Miter(s)

PAC-TITE Coping

PAC-Continuous Cleat Coping

Tapered Flat

PROJECT:

ARCHITECT:

ROOFING CONTRACTOR:

REPRESENTATIVE/DISTRIBUTOR:



Phone: 800-323-1960 Fax: 800-722-7150

www.pac-clad.com

e-mail: info@pac-clad.com

DATE: 10/18/10

DRN BY: JJC

CKD BY: SAK

SHT.# ___ OF ___

DWG# 41011-12589

A